



LILLNORD

next generation cooling technologies

RESERVEDELSKATALOG
SPARE PARTS CATALOGUE
ERSATZTEILKATALOG

Indhold / Contents / Inhalt

RUM / ROOM / RAUM

Blæser / Fan / Gebläse	3
Varme / Heating / Heizung	4
Døre / Doors / Türen:	
Hængsler / Hinges / Scharniere	7
Lukketøj / Fasteners / Befestigelungen	8
Pakninger / Seals / Dichtungen	12
Glas / Glass / Fensterglas	13
Underloft / Subceiling / Unterdecke	13
Skydedøre / Sliding doors / Schiebetüren	14
Lys / Light / Licht	17
Afløb / Drain / Ablauf	18

DAMP / STEAM / DAMPF

Beholder / Container / Behälter	20
Ventiler / Valves / Ventilen	22
Tilbehør / Accessories / Zubehör	24

EI / POWER / STROM

Computer / Computer / Computer	26
Følere / Sensors / Sensoren	27
Relæer / Relays / Relais	30
Hovedafbryder / Main switch / Hauptschalter	33
Strømforsyning / Power Supply / Stromversorgung	34
Spjældmotor / Flap motor / Klappenmotor	35

KØL / COOLING / KÜHLUNG

Fordamper / Evaporator / Verdampfer	36
SupraCooler / SupraCooler / SupraCooler	36

TILBEHØR / ACCESSORIES / ZUBEHÖR

Fugemasse / Sealant / Dichtungsmittel	37
---	----

Tegning Drawing Skizze	X	Varenummer Code number Bestellnummer	DK Beskrivelse	GB Description	DE Beschreibung
------------------------------	---	--	--------------------------	--------------------------	---------------------------

RUM / ROOM / RAUM

Blæser / Fan / Gebläse

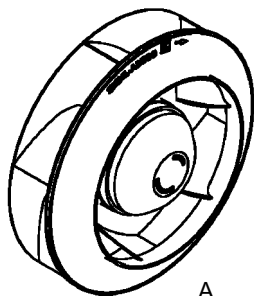

		DK	GB	DE
A	010 928	Blæsemotor R2E225-AT51-28	Fan motor R2E225-AT51-28	Gebläsemotor R2E225-AT51-28
B	015 258	Kondensator til blæsemotor 2,5 µf	Condensor for fan motor 2,5 µf	Kondensator für Gebläsemotor, 2,5 µf

FR	KR	R	FB	K	DC	DO	ML	SF
					X	X		

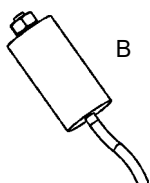

		DK	GB	DE
A	010 926	Blæsemotor RH22L-2EP.W6.1R	Fan motor RH22L-2EP.W6.1R	Gebläsemotor RH22L-2EP.W6.1R
B	015 256	Kondensator til blæsemotor	Condensor for fan motor	Kondensator für
A	010 927	Blæsemotor med UL certifikation	Fan motor with UL certification	Gebläsemotor mit UL- Zertifikation
B	015 254	Kondensator for blæsemotor med UL certifikation 2µf	Condensator for fan motor with UL certification 2µf	Kondensator für Gebläsemotor mit UL- Zertifikation 2µf

FR	KR	R	FB	K	DC	DO	ML	SF
X	X	X	X	X				

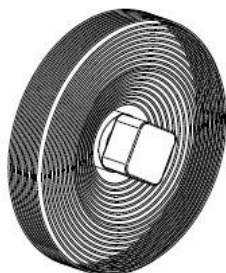

		DK	GB	DE
	013 744	Blæsemotor til Roller fordamper HVST-706-EP	Fan motor for Roller evaporator HVST-706-EP	Gebläsemotor für Roller Verdampfer HVST-706-EP

FR	KR	R	FB	K	DC	DO	ML	SF
							X	

BEMÆRK:

Vi anbefaler altid at udskifte kondensator, når blæser udskiftes.

PLEASE NOTE:

We always recommend that the condensor is changed together with the fan motor.

BITTE NOTIEREN:

Wir empfehlen stets, dass der Kondensator gleichzeitig mit dem Gebläsemotor ausgetauscht wird.

RUM / ROOM / RAUM

Varme / Heating / Heizung

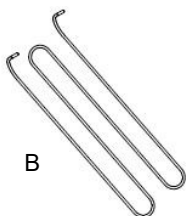
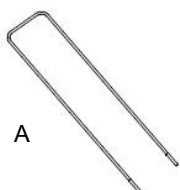
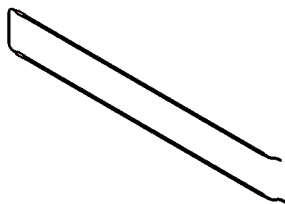

	DK	GB	DE	
	013 728	Varmelegeme for 4 kW fordampner	Heating element for 4 kW evaporator	Heizkörper für 4 kW Verdampfer
	013 729	Varmelegeme for 6 kW fordampner	Heating element for 6 kW Evaporator	Heizkörper für 6 kW Verdampfer
	013 732	Varmelegeme til drypbakke for 4 kW fordampner	Heating element driptray for 4 kW evaporator	Heizkörper für Tropfwanne für 4 kW Verdampfer
	013 733	Varmelegeme til drypbakke for 6 kW fordampner	Heating element driptray for 6 kW evaporator	Heizkörper für Tropfwanne für 6 kW Verdampfer
	032 170	Fjeder til varmelegeme til drypbakke, 2 styk nødv.	Spring for heating element for driptray, 2 pieces needed	Feder für Heizkörper für Tropfwanne, 2 Stück benötigt

FR	KR	R	FB	K	DC	DO	ML	SF
					X	X		X

	DK	GB	DE	
A	013 756	Varmelegeme for fordampner, Roller	Heating element for evaporator, Roller	Heizkörper für Verdampfer, Roller
B	013 746	Varmelegeme til drypbakke, Roller	Heating element driptray, Roller	Heizkörper für Tropfwanne, Roller

FR	KR	R	FB	K	DC	DO	ML	SF
							X	

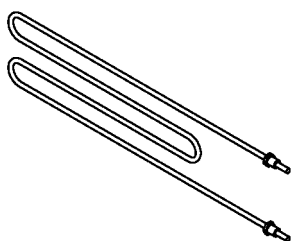

	DK	GB	DE	
	1302 1004	Varmelegeme, 1300 W 220V	Heating element, 1300 W 220V	Heizkörper, 1300 W 220V
K	1302 1000	El-boks med 1 x 1300 W	Electric box with 1 x 1300 W	Elektrobox mit 1 x 1300 W
K	1302 1001	El-boks med 2 x 1300 W	Electric box with 2 x 1300 W	Elektrobox mit 2 x 1300 W
K	1302 1002	El-boks med 3 x 1300 W	Electric box with 3 x 1300 W	Elektrobox mit 3 x 1300 W
K	1302 1003	El-boks med 4 x 1300 W	Electric box with 4 x 1300 W	Elektrobox mit 4 x 1300 W

K = Komplet med el-boks / Complete with el box / Komplett mit Elektrobox

	1302 1005	Varmelegeme, 1300 W 480V	Heating element, 1300 W 480V	Heizkörper, 1300 W 480V
--	-----------	--------------------------	------------------------------	-------------------------

FR	KR	R	FB	K	DC	DO	ML	SF
X	X	X				X		

Efter / After / Nach 2003

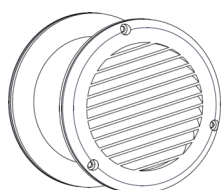

	DK	GB	DE	
	019 945	Trykudligningsventil 0-45 m ²	Pressure equalizing valve	Druckentlastungsventil

FR	KR	R	FB	K	DC	DO	ML	SF
				X	X		X	X

RUM / ROOM / RAUM

Varme / Heating / Heizung

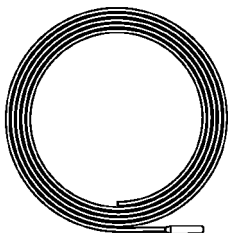

	DK	GB	DE
1906 9040	Afløbsvarme, selvregulerende 230V 2m, 31W/m	Heating f. drain, self-regulating 230V 2m, 31W/m	Ablaufheizung, selbstregulierend 230V 2m, 31W/m

FR	KR	R	FB	K	DC	DO	ML	SF
							X	

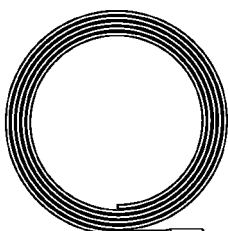

	DK	GB	DE
064 105	Varmekabel - afløb 1m, 55 W	Heating cable - drain 1m, 55 W	Heizkabel - Ablauf 1m, 55 W
064 093	Varmekabel - afløb 3m, 150 W	Heating cable - drain 3m, 150 W	Heizkabel - Ablauf 3m, 150 W
064 113	Varmekabel - afløb 4m, 200 W	Heating cable - drain 4m, 200 W	Heizkabel - Ablauf 4m, 200 W
064 109	Varmekabel - afløb 5m, 275 W	Heating cable - drain 5m, 275 W	Heizkabel - Ablauf 5m, 275 W
064 112	Varmekabel - afløb 6m, 330 W	Heating cable - drain 6m, 330 W	Heizkabel - Ablauf 6m, 330 W
064 111	Varmekabel - afløb 7m, 350 W	Heating cable - drain 7m, 350 W	Heizkabel - Ablauf 7m, 350 W

FR	KR	R	FB	K	DC	DO	ML	SF
					X	X		X

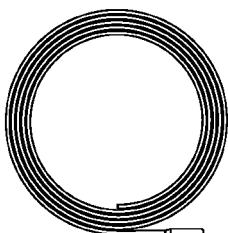

	DK	GB	DE
063 995	Varmekabel - dørkarm 4,1m 50 W	Heating cable - door frame 4,1m 50 W	Heizkabel - Türrahmen 4,1m 50 W

FR	KR	R	FB	K	DC	DO	ML	SF
X						X	X	

	DK	GB	DE
063 998	Varmekabel - dørkarm 4,1m 80 W	Heating cable - door frame 4,1m 80 W	Heizkabel - Türrahmen 4,1m 80 W

FR	KR	R	FB	K	DC	DO	ML	SF
					X			X

	DK	GB	DE
063 996	Varmekabel - dørkarm 5,1m 70 W	Heating cable - door frame 5,1m 70 W	Heizkabel - Türrahmen 5,1m 70 W

FR	KR	R	FB	K	DC	DO	ML	SF
							X	

DK:
En dørkarm =
2 kabler

GB:
One door frame =
2 cables

D:
Ein Türrahmen =
2 Kabel

RUM / ROOM / RAUM
 Varme / Heating / Heizung

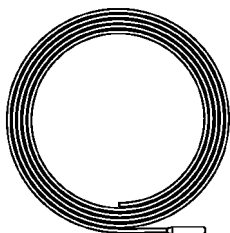

	DK	GB	DE
064 107	Varmekabel - drypbakke 3m 150 W	Heating cable - drip tray 3m 150 W	Heizkabel - Tropfwanne 3m 150 W
064 108	Varmekabel - drypbakke 4m 200 W	Heating cable - drip tray 4m 200 W	Heizkabel - Tropfwanne 4m 200 W

FR	KR	R	FB	K	DC	DO	ML	SF
					X	X		

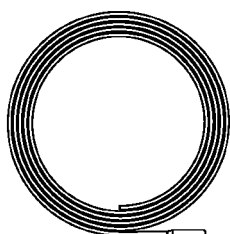

	DK	GB	DE
064 115	Varmekabel - gulv SK100 60 W 6m	Heating cable - floor SK100 60 W 6m	Heizkabel - Boden SK100 60 W 6m
064 117	Varmekabel - gulv SK100 90 W 9m	Heating cable - floor SK100 90 W 9m	Heizkabel - Boden SK100 90 W 9m
064 118	Varmekabel - gulv SK100 120 W 12m	Heating cable - floor SK100 120 W 12m	Heizkabel - Boden SK100 120 W 12m
064 121	Varmekabel - gulv SK100 180 W 18m	Heating cable - floor SK100 180 W 18m	Heizkabel - Boden SK100 180 W 18m
064 122	Varmekabel - gulv SK100 360 W 36m	Heating cable - floor SK100 360 W 36m	Heizkabel - Boden SK100 360 W 36m
060015	Alutape rulle	Aluminum tape roll	Aluminium-Tape Rolle

FR	KR	R	FB	K	DC	DO	ML	SF
X	X	X						

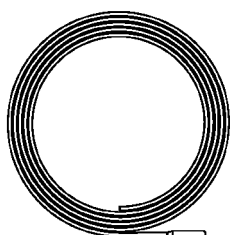

	DK	GB	DE
064 055	Varmekabel - gulv 230V / 196 W 15m	Heating cable - floor 230V / 196 W 15m	Heizkabel - Boden 230V / 196 W 15m
064 057	Varmekabel - gulv 230V / 296 W 20m	Heating cable - floor 230V / 296 W 20m	Heizkabel - Boden 230V / 296 W 20m
064 059	Varmekabel - gulv 230V / 350 W 27m	Heating cable - floor 230V / 350 W 27m	Heizkabel - Boden 230V / 350 W 27m
064 061	Varmekabel - gulv 230V / 453 W 35m	Heating cable - floor 230V / 453 W 35m	Heizkabel - Boden 230V / 453 W 35m
064 063	Varmekabel - gulv 230V / 657 W 45m	Heating cable - floor 230V / 657 W 45m	Heizkabel - Boden 230 / 657 W 45m
064 065	Varmekabel - gulv 230V / 780 W 60m	Heating cable - floor 230V / 780 W 60m	Heizkabel - Boden 230V / 780 W 60m

FR	KR	R	FB	K	DC	DO	ML	SF
					X			X

RUM / ROOM / RAUM

Hængsler / Hinges / Scharniere

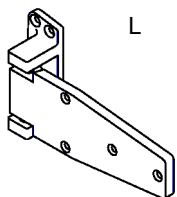

L

		DK	GB	DE
L	012 644	Hængsel, krom, venstre	Hinge, chrome, left	Scharnier, Chrom, Links
R	012 645	Hængsel, krom, højre til 90 + 130 mm døre	Hinge, chrome, right for 90 + 130 mm doors	Scharnier, Chrom, Rechts für 90 + 130 mm Türen

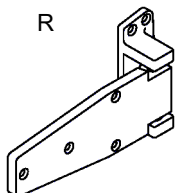

R

FR	KR	R	FB	K	DC	DO	ML	SF
X	X				X	X	X	X

Efter / After / Nach 2003

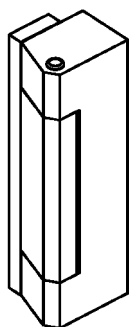

		DK	GB	DE
	012 526	Hængsel, krom til 60 mm døre.	Hinge, chrome for 60 mm doors.	Scharnier, Chrom für 60 mm Türen

FR	KR	R	FB	K	DC	DO	ML	SF
	X	X	X	X				

Efter / After / Nach 1993



A

		DK	GB	D
A	012 613	Dørstop M6 - 2,5 cm	Door stop M6 - 2.5 cm	Türstopper M6 - 2,5 cm
B	1311 5189	Beslag for dørstop	Bracket for door stop	Halterung für Türstopper

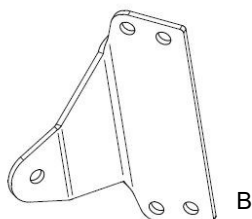

B

FR	KR	R	FB	K	DC	DO	ML	SF
X	X				X	X	X	X

Efter / After / Nach 2003

RUM / ROOM / RAUM

Lukketøj / Fasteners / Befestigungen

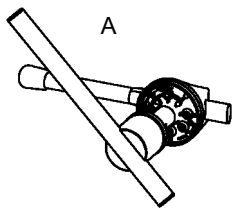

	Single door	DK	GB	DE
A	012 667	Håndtag, rustfri 1 punkt enkelt, 45° - 90mm	Handle, stainless steel, 1point, single, 45° - 90mm	Griff, Edelstahl 1Punkt, einzel, 45° - 90mm
B	012 628	Håndtag, indvendig 1 punkt 90mm, til 012667	Handle, inside 1point 90mm, for 012667	Griff, innen 1Punkt 90mm, für 012667

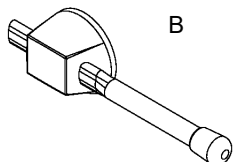

FR	KR	R	FB	K	DC	DO	ML	SF
X	X	(X)	X	X	X	X		X

Efter / After / Nach 2007

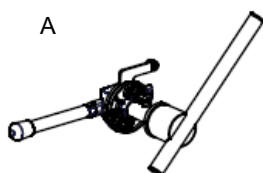

	Double door	DK	GB	DE
A	012 668	Håndtag, rustfri, 2 punkt dobbel, 45° - 90mm	Handle, stainless steel, 2 point, double, 45° - 90mm	Griff, Edelstahl, 2 Punkt, doppel, 45° - 90mm
B	012 662	Håndtag, indvendig 2 punkt 90mm, til 012668	Handle, inside 2 point 90mm, for 012668	Griff, innen 2 Punkt 90mm, für 012668

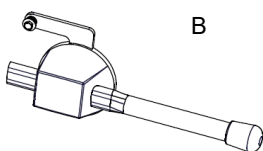

FR	KR	R	FB	K	DC	DO	ML	SF
X	X	(X)				X		

Efter / After / Nach 2013

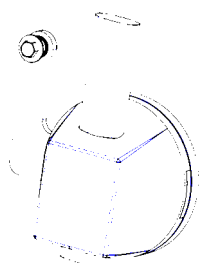

	DK	GB	DE
012 663	Lukker, TOP 90mm, 2 punkt	Internal shutter, TOP 90mm, 2 point	Verschluss, OBEN 90mm, 2 Punkt

FR	KR	R	FB	K	DC	DO	ML	SF
X	X	(X)						

Efter / After / Nach 2013

RUM / ROOM / RAUM

Lukketøj / Fasteners / Befestigungen

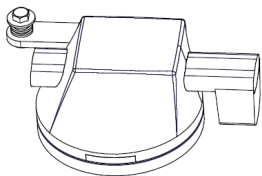

	DK	GB	DE
012 664	Lukker, BUND 90mm, 2 punkt	Internal shutter, BOTTOM 90mm, 2 point	Verschluss, UNTEN 90mm, 2 Punkt

FR	KR	R	FB	K	DC	DO	ML	SF
X	X	(X)						

Efter / After / Nach 2013

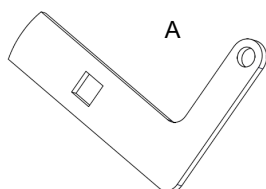

	DK	GB	DE
A 012 661	Arm for trækstang	Lever for draw rod	Hebel für Ziehstange
B 012 665	Flange 2 punkt, indvendig	Flange 2 point, inside	Flansch 2 Punkt, innen

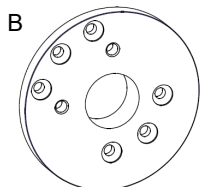

FR	KR	R	FB	K	DC	DO	ML	SF
X	X	(X)						

Efter / After / Nach 2013



	DK	GB	DE
1208 9420	Trækstang, dobbelt dør 1990 mm, 6mm AL	Draw rod, double door 1990 mm, 6mm AL	Ziehstange, Doppeltür 1990 mm, 6mm AL
1208 9422	Trækstang, dobbelt dør 2090 mm, 6mm AL Erstatning for 1211 9420	Draw rod, double door 2090 mm, 6mm AL Replacement for 1211 9420	Ziehstange, Doppeltür 2090 mm, 6mm AL Ersatz für 1211 9420

FR	KR	R	FB	K	DC	DO	ML	SF
X	X	(X)						

RUM / ROOM / RAUM

Lukketøj / Fasteners / Befestigelungen

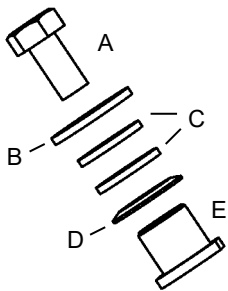

		DK	GB	DE
	1208 9800	Skrue sæt for trækstang, dobbelt døre	Screw set for draw rod, double doors	Schrauben-Set für Ziehstange, doppelt Türen
A	011 712	Maskinskrue A2 6x12	Screw A2 6x12	Schraube A2 6x12
B	011 735	Skærmskive A2, rustfri 6,4x18mm	A2, SS 6,4x18mm	A2, rostfrei 6,4x18mm
C	012 630	Nylonskive for trækstang	Nylon washer for draw rod	Nylonscheibe für Ziehstange
D	012 636	Fjederskive for trækstang	Spring washer for draw rod	Federscheibe für Ziehstange
E	012 637	Møtrik til trækstang	Nut for draw rod	Mutter für Ziehstange

FR	KR	R	FB	K	DC	DO	ML	SF
X	X	(X)						

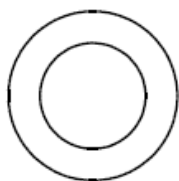

		DK	GB	DE
	012 624	Afstandsskive til håndtag	Washer/spacer for handle	Abstandhalter für Griff

FR	KR	R	FB	K	DC	DO	ML	SF
X	X	(X)						

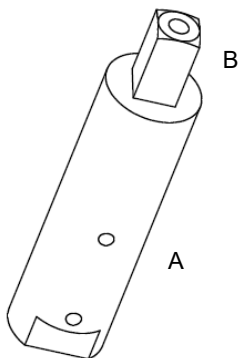

		DK	GB	DE
A	012 669	Aksel, udv. håndtag (nylon) 90mm dør	Shaft/axle outside handle (nylon) 90mm door	Achse Handgriff außen (Nylon) 90mm Tür
A	012 670	Aksel, udv. håndtag (nylon) 130mm dør	Shaft/axle outside handle (nylon) 130mm door	Achse Handgriff außen (Nylon) 130mm Tür
B	012 676	Aksel, indiv. Håndtag (stål), længde 94mm	Shaft/axle inside handle (steel) , length 94mm	Achse Handgriff innen (Stahl) , Länge 94mm

FR	KR	R	FB	K	DC	DO	ML	SF
X	X	(X)	X	X	X	X		X

RUM / ROOM / RAUM

Lukketøj / Fasteners / Befestigelungen

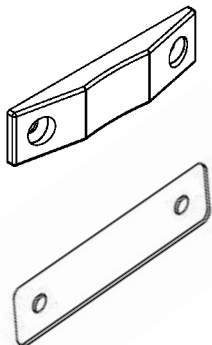

	DK	GB	DE
012 649	Dørkile til håndtag, 9mm	Wedge for doorframe, 9mm	Türkeil, 9mm
1211 9401	Underlag for kile	Base for wedge	Unterlage für Türkeil

FR	KR	R	FB	K	DC	DO	ML	SF
X	X	(X)	X	X	X	X		X

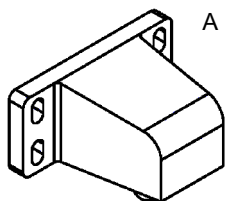

	DK	GB	DE
A 012 610	Lukkebeslag 60mm døre, enkelt/dobbelt	Door catch 60mm, single/double	Verschlussbeschlag 60mm Türen, einzel/doppelt
B 012 611	Kile for lukkebeslag 60mm døre, enkelt/dobbelt	Wedge door catch 60mm, single/double	Keil Verschlussbeschlag 60mm Türen, einzel/doppelt

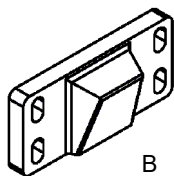

FR	KR	R	FB	K	DC	DO	ML	SF
		X	X	X				

RUM / ROOM / RAUM

Pakninger / Seals / Dichtungen

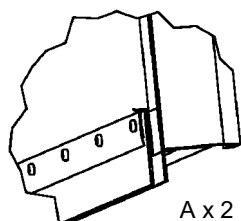

A x 2

		DK	GB	DE
A	012 650	Slæbeliste, silikone S40 2mm x 50mm	Door sealing, silicone S40 2mm x 50mm	Schleppliste, Silikon S40 2mm x 50mm
B	012 653	Slæbeliste, silikone S60 2mm x 100mm	Door sealing, silicone S60 2mm x 100mm	Schleppliste, Silikon S60 2mm x 100mm
	012652	Slæbeliste silikone 3 mm x 68 mm	Door sealing silicone 3mm x 68 mm	Schleppleiste Silikon 3mm x 68 mm

L = Dørbredde / Door width / Türbreite

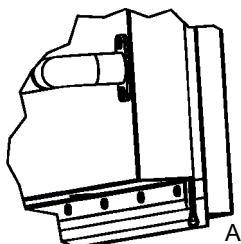

A + B

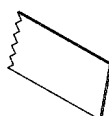

FR	KR	R	FB	K	DC	DO	ML	SF
X	X	X	X	X	X	X		X

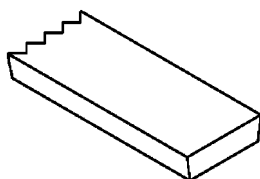

		DK	GB	DE
	012 692	Dørpakning m/smig 12x44x2050 mm 3 stk. til enkeltør 5 stk. til dobbeltdør 2 stk. til SL luge	Door Seal 12x44x2050 mm 3 pcs for single door 5 pcs for double door 2 pcs for SL hatch	Türdichtung 12x44x2050 mm 3 Stck für Einzeltür 5 Stck für Doppeltür 2 Stck für ML Luke

FR	KR	R	FB	K	DC	DO	ML	SF
X	X	X	X	X	X	X	X	X



		DK	GB	DE
	014 652	M profiliste, dørkarm	M profile list, door frame	M Profiliste, Türrahmen

FR	KR	R	FB	K	DC	DO	ML	SF
X	X	X	X	X	X	X	X	X

RUM / ROOM / RAUM

Glas / Glass / Fensterglas

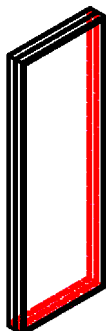

	DK	GB	DE
015 423	Glas, 32x350x1000 2L/VK	Glass, 32x350x1000 2L/VK	Glasscheibe, 32x350x1000 2L/VK
015 426	Glas, 60x350x1000 3L/VK	Glass, 60x350x1000 3L/VK	Glasscheibe, 60x350x1000 3L/VK
015 422	Glas, 32x270x1000 2L/VK	Glass, 32x270x1000 2L/VK	Glasscheibe, 32x270x1000 2L/VK
015 429	Glas, 60x270x1000 3L/VK	Glass, 60x270x1000 3L/VK	Glasscheibe, 60x270x1000 3L/VK
1208 9450	Montage kit, rude t/ 60+90'er dør, 350x1000	Mounting kit, glass 350x1000	Montage-Kit, Scheibe 350x1000
1208 9452	Montage kit, rude t/60+90'er dør, 270x1000	Mounting kit, glass 270x1000	Montage-Kit, Scheibe 270x1000
1208 9454	Montage Kit, rude t/70'er dør, 270x1000	Mounting kit, glass f/70 door, 270x1000	Montage-Kit, Scheibe f/70'er Tür, 270x1000
1208 9455	Montage Kit, rude t/70'er dør, 350x1000	Mounting kit, glass f/70 door, 350x1000	Montage-Kit, Scheibe f/70'er Tür, 350x1000
0000 250	Manual Udskiftning af rude	Manual Changing the glass	Manual Austausch von der Scheibe

FR	KR	R	FB	K	DC	DO	ML	SF
X	X	X	X	X				

RUM / ROOM / RAUM

Underloft / Subceiling / Unterdecke

	DK	GB	DE
010 077	Underloft, Stadurplade FB1, 19mm	Subceiling, Stadur plate FB1, 19mm	Unterdecke, Stadur Platte FB1, 19mm

FR	KR	R	FB	K	DC	DO	ML	SF
X	X	X	X	X	X	X		X

RUM / ROOM / RAUM

Skydedøre / Sliding doors / Schiebetüren

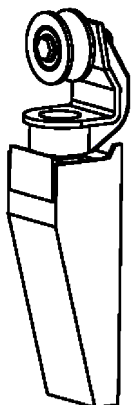

	DK	GB	DE
012 584	Hjul med ophæng	Wheel with suspension	Rad mit Aufhängung

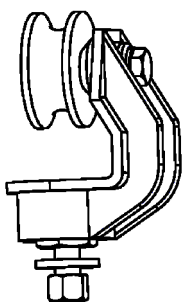

	DK	GB	DE
012 583	Hjul med leje, komplet	Wheel with bearing, complete	Rad mit Kugellager, Komplett
012 578	Hjul	Wheel	Rad

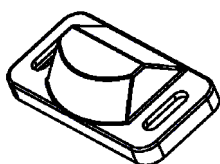

	DK	GB	DE
012 571	Bundstyr, forrest	Bottom control, front	Bodensteuerung, Front

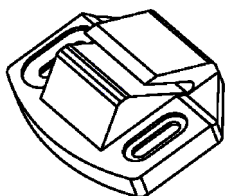

	DK	GB	DE
012 572	Bundstyr, bagerst	Bottom control, rear	Bodensteuerung, hinten

FR	KR	R	FB	K	DC	DO	ML	SF
X	X	X	X	X	X	X		X

RUM / ROOM / RAUM

Skydedøre / Sliding doors / Schiebetüren

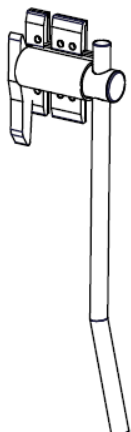

	DK	GB	DE
012 598	Håndtag, udvendig	Handle, external	Handgriff, außen

FR	KR	R	FB	K	DC	DO	ML	SF
X	X	X	X	X	X	X		X

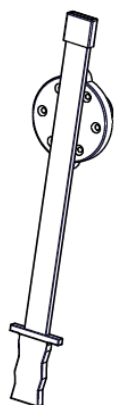

	DK	GB	DE
012 570	Håndtag, indvendig	Handle, internal	Handgriff, innen

FR	KR	R	FB	K	DC	DO	ML	SF
X	X	X	X	X	X	X		X

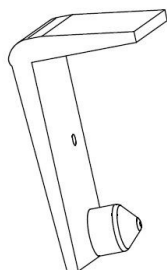

	DK	GB	DE
012 577	Endestop, skydedør	Endstop, sliding door	Endestop, Schiebetür

FR	KR	R	FB	K	DC	DO	ML	SF
X	X	X	X	X	X	X		X

RUM / ROOM / RAUM

Skydedøre / Sliding doors / Schiebetüren

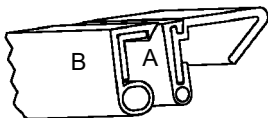

		DK	GB	DE
A	012 560	Slæbeliste til skydedør I	Sealing for sliding door I	Schleppliste für Schiebetür I
B	012 592	Slæbeliste til skydedør II	Sealing for sliding door II	Schleppliste für Schiebetür II

L = Dørbredde / Door width / Türbreite

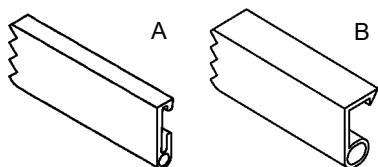

FR	KR	R	FB	K	DC	DO	ML	SF
X	X	X	X	X	X	X		X

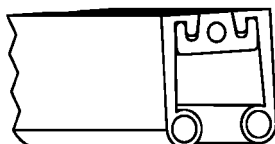

		DK	GB	DE
	012 591	Dørpakning til skydedør, højde 35mm	Door seal for sliding door, height 35mm	Türdichtung für Schiebetür, Höhe 35mm

L = Dør / Door / Tür (Hx2 + B) x 2

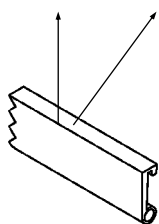

2 stk. /pcs /Stck

FR	KR	R	FB	K	DC	DO	ML	SF
X	X	X	X	X	X	X		X

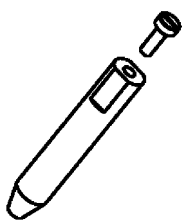

		DK	GB	DE
	012 600	Anti opspring	Anti rebound	Entprellung

FR	KR	R	FB	K	DC	DO	ML	SF
X	X	X	X	X	X	X		X

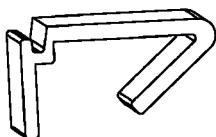

		DK	GB	D
	012 595	Styreskinne, bund længde 1760mm	Bottom Guide rail length 1760mm	Untere Führungsschiene Länge 1760mm

FR	KR	R	FB	K	DC	DO	ML	SF
X	X	X	X	X	X	X		X

RUM / ROOM / RAUM

Lys / Light / Licht



	DK	GB	DE
064 894	LED PowerBar 50cm, 24V, 7,2W, 0,3A, 30.000 timer	LED PowerBar 50cm, 24V, 7,2W, 0,3A, 30.000 hours	LED PowerBar 50cm, 24V, 7,2W, 0,3A, 30.000 Stunden
064 895	LED PowerBar 100cm, 24V, 14,4W, 0,6A, 30.000 timer	LED PowerBar 100cm, 24V, 14,4W, 0,6A, 30.000 hours	LED PowerBar 100cm, 24V, 14,4W, 0,6A, 30.000 Stunden

Strømforsyning, se side 35

Power supply, see page 35

Stromversorgung, siehe Seite 35

FR	KR	R	FB	K	DC	DO	ML	SF
X	X	X	X	X	X	X		

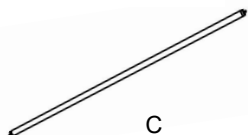
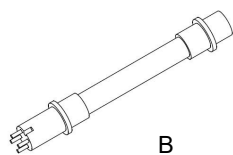
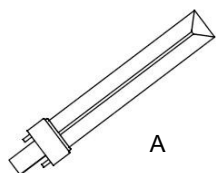

	DK	GB	DE
A 064 841	UV lysrør, PLS 9W G23	UV neon tube, PLS 9W G23	UV Leuchtstoffröhre, PLS 9W G23
B 064 839	UV lysrør UV2 ICE	UV neon tube UV2 ICE	UV Leuchtstoffröhre UV2
C 064 843	UV lysrør, 36W	UV neon tube, 36W	UV Leuchtstoffröhre, 36W

FR	KR	R	FB	K	DC	DO	ML	SF
			X					

RUM / ROOM / RAUM

Afløb / Drain / Ablauf

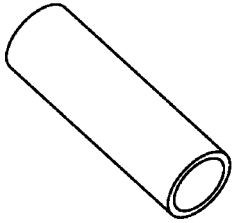

	DK	GB	DE
011 172	PP rør Ø32	PP Pipe Ø32	PP Rohr Ø32

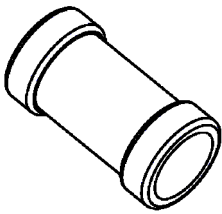

	DK	GB	DE
011 204	PP dobbeltmuffe Ø50mm	PP Double coupler Ø50mm	PP Doppelmuffe Ø50mm
011 208	PP dobbeltmuffe Ø32mm	PP Double coupler Ø32mm	PP Doppelmuffe Ø32mm

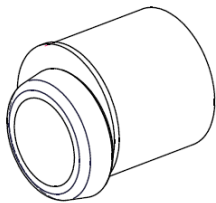

	DK	GB	DE
011 205	PP overgang Ø50-32mm	PP transition Ø50-32mm	PP Übergang Ø50-32mm

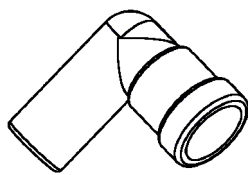

	DK	GB	DE
011 207	PP bøjning Ø32 mm 90°	PP Fitting Ø32mm 90°	PP Fitting Ø32mm 90°
011 206	PP bøjning Ø32 mm 45°	PP Fitting Ø32mm 45°	PP Fitting Ø32mm 45°
011 194	PP bøjning Ø32 mm 30°	PP Fitting Ø32mm 30°	PP Fitting Ø32mm 30°
011 193	PP bøjning Ø32 mm 15°	PP Fitting Ø32mm 15°	PP Fitting Ø32mm 15°

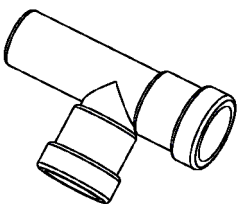

	DK	GB	DE
011 209	PP Tee Ø32 90°	PP Branch pipe Ø32 90°	PP Abzweigrohr Ø32 90°

FR	KR	R	FB	K	DC	DO	ML	SF
X	X	X	X	X	X	X	X	X

RUM / ROOM / RAUM

Afløb / Drain / Ablauf

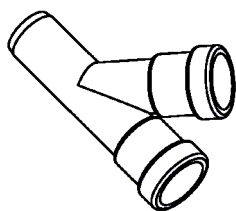

	DK	GB	DE
011 210	PP Grenrør Ø32 45°	PP Branch pipe Ø32 45°	PP Abzweigrohr Ø32 45°

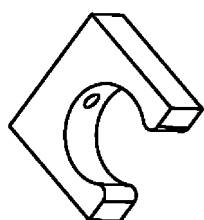

	DK	GB	DE
019 105	Rørholder 32mm	Pipe suspension 32mm	Rohrhalter 32mm

FR	KR	R	FB	K	DC	DO	ML	SF
X	X	X	X	X	X	X	X	X

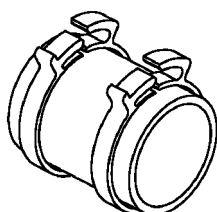

	DK	GB	DE
4005 1126	Muffe, beholder/ventil	Socket, container/valve	Muffe, Behälter/Ventil
014 311	Siliconeslange Ø50x4mm	Silicone hose Ø50x4mm	Siliconeschlauch Ø50x4mm

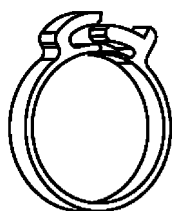

	DK	GB	DE
019 147	Spændebånd, 40-60 mm RF	Clamp, 40-60 mm SS	Schelle, 40-60 mm RF
019 146	Spændebånd, 32-44 mm RF	Clamp, 32-44 mm SS	Schelle, 32-44 mm RF

FR	KR	R	FB	K	DC	DO	ML	SF
X	X	X	X			X		

DAMP / STEAM / DAMPF

Beholder / Container / Behälter

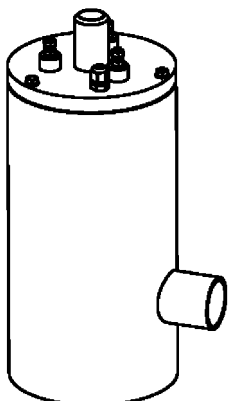

	DK	GB	DE
4005 1038	Beholder K E175/30 A32	Container K E175/30 A32	Behälter K E175/30 A32
4005 1037	Beholder K E175/10 A32	Container K E175/10 A32	Behälter K E175/10 A32
4005 1121	Beholder K E175/5 A32	Container K E175/5 A32	Behälter K E175/5 A32
4005 1136	Beholder K E175/R A32	Container K E175/R A32	Behälter K E175/R A32
4005 1122	Beholder K E175/Z A32	Container K E175/Z A32	Behälter K E175/Z A32

FR	KR	R	FB	K	DC	DO	ML	SF
X	X	X	X			X		

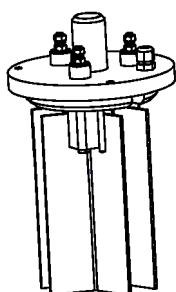

	DK	GB	DE
A 4005 1035	Elektrode top E175/30 A32	Electrode top E175/30 A32	Elektrodentop E175/30 A32
A 4005 1036	Elektrode top E175/10 A32	Electrode top E175/10 A32	Elektrodentop E175/10 A32
A 4005 1092	Elektrode top E175/5 A32	Electrode top E175/5 A32	Elektrodentop E175/5 A32
B 4005 1117	Elektrode top E175/R A32	Electrode top E175/R A32	Elektrodentop E175/R A32
C 4005 1115	Elektrode top E175/Z A32	Electrode top E175/Z A32	Elektrodentop E175/Z A32
4005 1091	Afstandsstykker til 5mm elektroder	Plastic spacer for 5mm electrodes	Abstandshalter für 5mm Elektroden

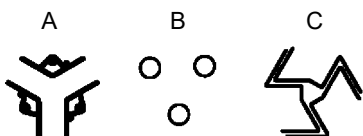

FR	KR	R	FB	K	DC	DO	ML	SF
X	X	X	X			X		

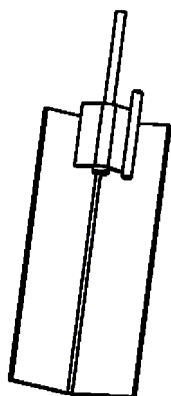

	DK	GB	DE
4005 1015	Elektrode 175/30 antimagnetisk nikkel	Electrode 175/30 anti-magnetic nickel	Elektrode 175/30 Antimagnetisch Nickel
4005 1016	Elektrode 175/10 antimagnetisk nikkel	Electrode 175/10 anti-magnetic nickel	Elektrode 175/10 Antimagnetisch Nickel
4005 1093	Elektrode 175/5 antimagnetisk nikkel	Electrode 175/5 anti-magnetic nickel	Elektrode 175/5 Antimagnetisch Nickel
4005 1014	Elektrode 175/R antimagnetisk nikkel	Electrode 175/R anti-magnetic nickel	Elektrode 175/R Antimagnetisch Nickel
4005 1112	Elektrodesæt E175-1,5/Z A32	Set of electrodes E175-1,5/Z A32	Elektrodesæt E175-1,5/Z A32

FR	KR	R	FB	K	DC	DO	ML	SF
X	X	X	X			X		

Side 20
Page 20
Seite 20

BEMÆRK:
Ved udskiftning af elektroder anbefaler vi samtidig udskiftning af kontaktor K2, nr. 061710.

PLEASE NOTE:
When exchanging the electrodes we recommend simultaneous exchange of Contactor, K2 no. 061710

BITTE NOTIEREN:
Beim Austausch der Elektroden empfehlen wir gleichzeitigen Austausch von Schütz, K2, Nr. 061710

DAMP / STEAM / DAMPF
 Beholder / Container / Behälter

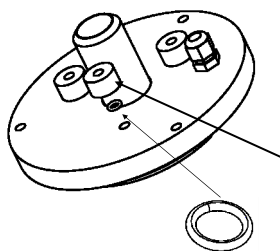

	DK	GB	DE
4005 1007	Låg uden elektroder A32	Top with out elektrodes A32	Deckel ohne Elektroden A32
011 746	O-ring EPDM 5,3x2,4	O-ring EPDM 5,3x2,4	O-Ring EPDM 5,3x2,4
4005 1008	Elektrodebøsning PP t/M6	Electrode bushing PP f/M6	Elektrodebuchse PP f/M6

FR	KR	R	FB	K	DC	DO	ML	SF
X	X	X	X			X		

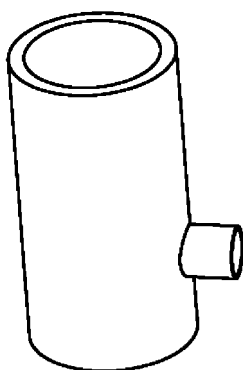

	DK	GB	DE
4005 1003	Beholder m/sideudløb	Container w/side drainage	Behälter m/Entleerung Seitwärts

FR	KR	R	FB	K	DC	DO	ML	SF
X	X	X	X			X		

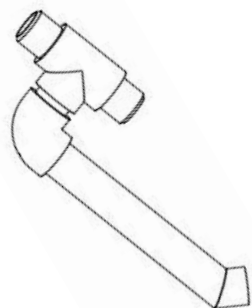

	DK	GB	DE
4005 1131	Afløb, 2 beholdere / 1 ventil	Drain, 2 containers / 1 valve	Ablauf, 2 Behälter / 1 Ventil

FR	KR	R	FB	K	DC	DO	ML	SF
X	X	X	X			X		

DAMP / STEAM / DAMPF

Ventiler / Valves / Ventile

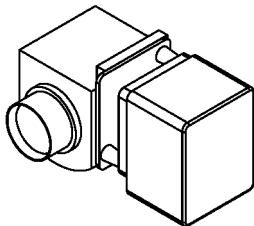

	DK	GB	DE
013 100	Motorventil 24 VAC NC	Motor valve 24 VAC NC	Motorventil 24 VAC NC
013 104	Motorventil 220 VAC NO	Motor valve 220 VAC NO	Motorventil 220 VAC NO
013 106	Motorventil 115 VAC NO	Motor valve 115 VAC NO	Motorventil 115 VAC NO

FR	KR	R	FB	K	DC	DO	ML	SF
X	X	X	X			X		

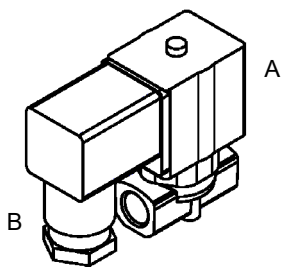

	DK	GB	DE
A 013 121	Magnetventil SMC 24 VAC	Solenoid valve SMC 24 VAC	Magnetventil SMC 24 VAC
B 013 126	Stik til Magnetventil	Plug for solenoid valve	Stecker für Magnetventil
A 013 122	Magnetventil SMC 24 VDC UL	Solenoid valve SMC 24 VDC UL	Magnetventil SMC 24 VDC UL
A 013 123	Magnetventil SMC 24 VAC UL	Solenoid valve SMC 24VAC UL	Magnetventil SMC 24 VAC UL

FR	KR	R	FB	K	DC	DO	ML	SF
X	X	X	X			X		

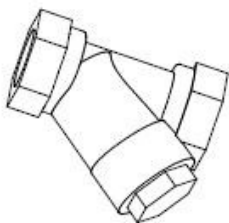

	DK	GB	DE
013 055	Filter 3/8"	Filter 3/8"	Filter 3/8"

FR	KR	R	FB	K	DC	DO	ML	SF
X	X	X	X			X		

DAMP / STEAM / DAMPF

Ventiler / Valves / Ventile

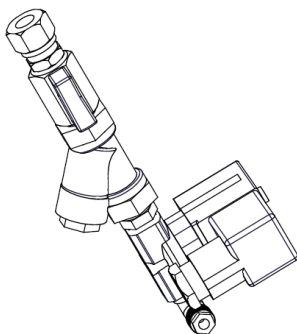

	DK	GB	DE
4005 1077	Magnetventil m/filter	Solenoid valve w/filter	Magnetventil m/Filter

FR	KR	R	FB	K	DC	DO	ML	SF
X	X	X	X			X		

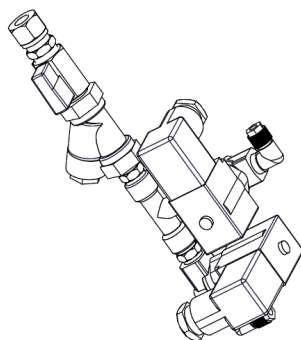

	DK	GB	DE
4005 1118	Magnetventil m/filter dobbelt	Solenoid valve w/filter double	Magnetventil m/Filter dobbelt

FR	KR	R	FB	K	DC	DO	ML	SF
X	X	X	X			X		

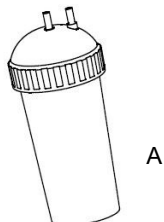

	DK	GB	DE
A 013 152	LN Vandfilter type 2,	LN Water filter type 2,	LN Wasserfilter Typ 2,
A 013 154	LN Vandfilter type 3,	LN Water filter type 3,	LN Wasserfilter Typ 3,
B 013 151	LN vinkel 10mm/6mm	LN bracket 10mm/6mm	LN Winkel 10mm/6mm

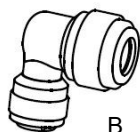

FR	KR	R	FB	K	DC	DO	ML	SF
X	X	X	X			X		

DAMP / STEAM / DAMPF

Tilbehør / Accessories / Zubehör

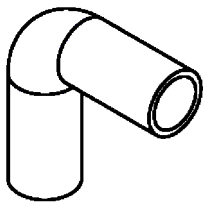

	DK	GB	DE
014 303	Dampslange 32 mm, 90°	Steam hose 32 mm, 90°	Dampfschlauch 32 mm, 90°

FR	KR	R	FB	K	DC	DO	ML	SF
X	X	X	X			X		

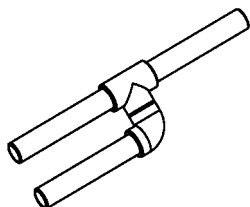

	DK	GB	DE
4005 1124	Forgrening, h-form	Branching, h-shape	Verzweigung, h-Form

FR	KR	R	FB	K	DC	DO	ML	SF
X	X	X	X			X		

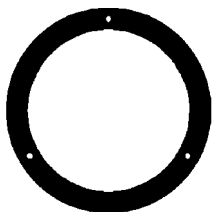

	DK	GB	DE
013 094	Gummipakning, Ø 160mm til PG-beholder	Rubber seal, Ø 160mm for PG-container	Gummidichtung, Ø 160mm für PG-Behälter

FR	KR	R	FB	K	DC	DO	ML	SF
X	X	X	X			X		

DAMP / STEAM / DAMPF
Tilbehør / Accessories / Zubehör

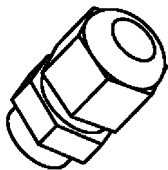

	DK	GB	DE
062 834	PG 7 forskrning BS-11	PG 7 coupling BS-11	PG 7 Verschraubung BS-11

FR	KR	R	FB	K	DC	DO	ML	SF
X	X	X	X			X		

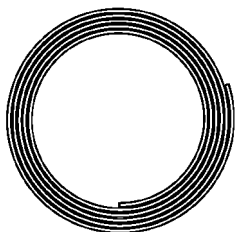

	DK	GB	DE
014 315	Vandslange Ø 6/4,5 mm	Water hose Ø 6/4,5 mm	Wasserschlauch Ø 6/4,5 mm

FR	KR	R	FB	K	DC	DO	ML	SF
X	X	X	X			X		

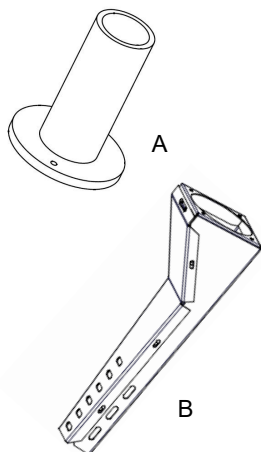

	DK	GB	DE
A 40051082	Dampdyse	Steam nozzle	Dampfdüse
B 2006 1350	Dampfordeler 1,5 - 3 kW	Steam divider, 1,5 - 3 kW	Dampfverteiler, 1,5 - 3 kW

FR	KR	R	FB	K	DC	DO	ML	SF
X	X	X	X			X		

EL / POWER / STROM

Computer / Computer / Computer

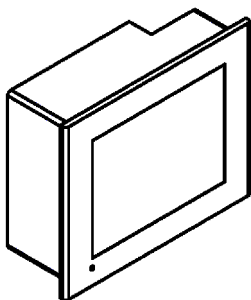

Bemærk:
Ved vandskade, ingen ombytning.
Note:
By water damage, no replacement.
Beachten:
Durch Wasser beschädigt, kein Ersatz.

Efter / After / Nach 2011

	DK	GB	DE
9088 0127	TSC2002 Touch Computer 6"	TSC2002 Touch Computer 6"	TSC2002 Touch Computer 6"

FR	KR	R	FB	K	DC	DO	ML	SF
X	X	X	X			X		

	DK	GB	DE
9088 0129	TSC2002 Touch Computer 6"	TSC2002 Touch Computer 6"	TSC2002 Touch Computer 6"

FR	KR	R	FB	K	DC	DO	ML	SF
				X	X			X

	DK	GB	DE
9088 0106	TSC2002 Touch Computer 6"	TSC2002 Touch Computer 6"	TSC2002 Touch Computer 6"

FR	KR	R	FB	K	DC	DO	ML	SF
							X	

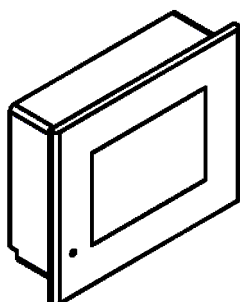

Bemærk:
Ved vandskade, ingen ombytning.
Note:
By water damage, no replacement.
Beachten:
Durch Wasser beschädigt, kein Ersatz.

Efter / After / Nach 2011

	DK	GB	DE
9088 0121	TSC1902 Touch Computer 4"	TSC1902 Touch Computer 4"	TSC1902 Touch Computer 4"

FR	KR	R	FB	K	DC	DO	ML	SF
X	X	X	X			X		

	DK	GB	DE
9088 0122	TSC1902 Touch Computer 4"	TSC1902 Touch Computer 4"	TSC1902 Touch Computer 4"

FR	KR	R	FB	K	DC	DO	ML	SF
				X	X			X

	DK	GB	DE
9088 0104	TSC1902 Touch Computer 4"	TSC1902 Touch Computer 4"	TSC1902 Touch Computer 4"

FR	KR	R	FB	K	DC	DO	ML	SF
							X	

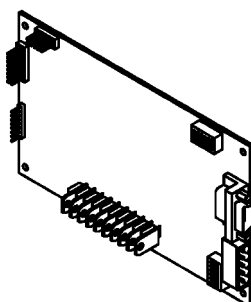

	DK	GB	DE
060 352	Flex/O 3010, 10 Out - 10 In	Flex/O 3010, 10 Out - 10 In	Flex/O 3010, 10 Out - 10 In
066 010	Buskabel Touch RS422 2 m, 3x0,25	Bus cable Touch RS422 2 m, 3x0,25	Bus-Kabel Touch RS422 2 m, 3x0,25

FR	KR	R	FB	K	DC	DO	ML	SF
X	X	X	X	X	X	X	X	X

Efter / After / Nach 2011

EL / POWER / STROM

Følere / Sensors / Sensoren

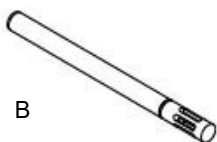
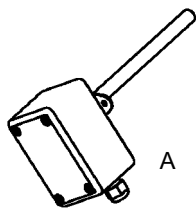

		DK	GB	DE
A	060 778	Hygrostat FG80H, elektronisk, special for brødsyre.	Hygrostat FG80H, electronic, special for dough acid.	Hygrostat FG80H, elektronisch, besonderes für gesäuerten Teig.
B	060 771	Hygrostat EE061 4-20mA	Hygrostat EE061 4-20mA	Hygrostat EE061 4-20mA

FR	KR	R	FB	K	DC	DO	ML	SF
X	X	X	X			X		



		DK	GB	DE
	060 195	PT100 temperaturføler	PT100 temperature sensor	PT100 Temperaturfühler

FR	KR	R	FB	K	DC	DO	ML	SF
X	X	X	X	X	X	X	X	X

		DK	GB	DE
	0103 1055	PT100 afrimningsføler	PT100 defrost sensor	PT100 Abtaufühler

FR	KR	R	FB	K	DC	DO	ML	SF
					X	X	X	X

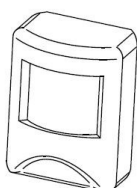

		DK	GB	DE
	060 200	Bevægelsesføler PIR for Touch computere	Motion sensor for Touch computers	Bewegungssensor PIR für Touch Computer

FR	KR	R	FB	K	DC	DO	ML	SF
				X	X			



		DK	GB	DE
	0103 1052	Lydgiver 5VDC 30MA 85 dB m/ ledning	Buzzer 5VDC 30MA 85 dB w/ cable	Summer 5VDC 30MA 85 dB m/ Kabel

FR	KR	R	FB	K	DC	DO	ML	SF
X	X	X	X	X	X	X	X	X

EL / POWER / STROM

Følere / Sensors / Sensoren

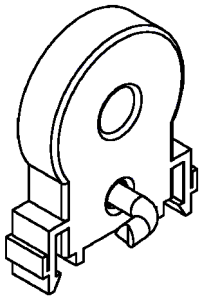

	DK	GB	DE
061 058	Måletransformer MI 20	Current transformer MI 20	Messwandler MI 20

FR	KR	R	FB	K	DC	DO	ML	SF
X	X	X	X			X		

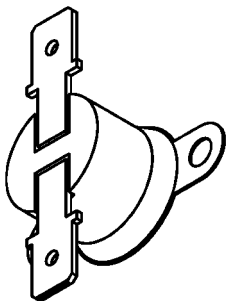

	DK	GB	DE
061 081	Overhedningssikring 70°	Sensor, superheating 70°	Überhitzungssicherung 70°

FR	KR	R	FB	K	DC	DO	ML	SF
X	X	X	X			X		

	DK	GB	DE
061 082	Overhedningssikring 10°	Sensor, superheating 10°	Überhitzungssicherung 10°

FR	KR	R	FB	K	DC	DO	ML	SF
					X		X	X

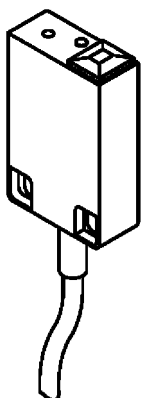

	DK	GB	DE
061 348	Niveauføler, kapacitiv 80°C Touch	Level sensor, capacitive 80°C Touch	Niveau-Sensor, kapazitiv 80°C Touch

FR	KR	R	FB	K	DC	DO	ML	SF
X	X	X	X			X		

EL / POWER / STROM

Følere / Sensors / Sensoren



	DK	GB	DE
061 088	Magnetaftaster SM07 til skydedøre	Magnetic switch SM07 for sliding doors	Magnetschalter SM07 für Schiebetüren

FR	KR	R	FB	K	DC	DO	ML	SF
X	X	X	X	X	X	X		X

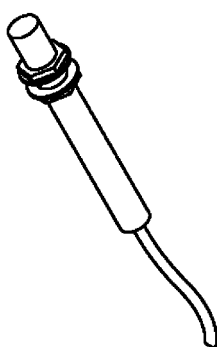

	DK	GB	DE
061 095	Magnetaftaster SM19 til døre	Magnetic switch SM19 for doors	Magnetschalter SM19 für Türen.

FR	KR	R	FB	K	DC	DO	ML	SF
X	X	X	X	X	X	X		X

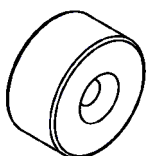

	DK	GB	DE
061 087	Stangmagnet S-200410	Bar magnet S-200410	Magnetstange S-200410

FR	KR	R	FB	K	DC	DO	ML	SF
X	X	X	X	X	X	X		X

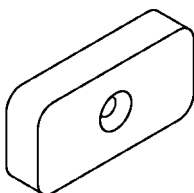

	DK	GB	DE
061 079	Magnet T-68N til skydedøre 10x25x50.	Magnet T-68N for sliding doors, 10x25x50.	Magnet T-68N für Schiebetüren, 10x25x50.

FR	KR	R	FB	K	DC	DO	ML	SF
X	X	X	X	X	X	X		X

EL / POWER / STROM

Relæer / Relays / Relais

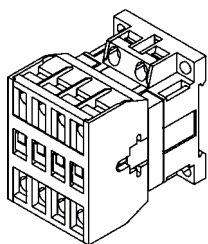

	DK	GB	DE
061 710	Kontaktor J7KN-10D-01 24V Damp - K2	Contactora J7KN-10D-01 24V Steam - K2	Schütz J7KN-10D-01 24V Dampf - K2
061 711	Kontaktor J7KN-10D-4 24V	Contactora J7KN-10D-4 24V	Schütz J7KN-10D-4 24V
061 713	Kontaktor J7KN18D01 24VAC, damp	Contactora J7KN18D01 24VAC, steam	Schütz J7KN18D01 24VAC Dampf
061 720	Kontaktor K3 10A01-230V	Contactora K3 10A01-230V	Schütz K3 10A01-230V
061 721	Kontaktor K3 10A10-230V	Contactora K3 10A10-230V	Schütz K3 10A10-230V
061 731	Kontaktor J7KN-22D-4 24VAC, varme	Contactora J7KN-22D-4 24VAC, heat	Schütz J7KN-22D-4 24VAC, Wärme
061 732	Kontaktor J7KN-22D-01 24VAC, damp	Contactora J7KN-22D-01 24VAC, steam	Schütz J7KN-22D-01 24VAC, Dampf
061 735	Kontaktor J7KN18D-4 24VAC, varme	Contactora J7KN18D-4 24VAC, heat	Schütz J7KN18D-4 24VAC Wärme
061 737	Kontaktor J7KN-18-01 230VAC	Contactora J7KN-18-01 230VAC	Schütz J7KN-18-01 230VAC
061 738	Kontaktor J7KN-22-01 230VAC	Contactora J7KN-22-01 230VAC	Schütz J7KN-22-01 230VAC

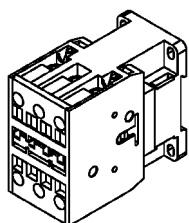

	DK	GB	DE
061 729	Kontaktor J7KN-32 24VAC uden hjælpekontakt	Contactora J7KN-32 24VAC without auxiliary contact	Schütz J7KN-32 24VAC ohne Hilfsschütz
061 739	Kontaktor J7KN-32 24VAC uden hjælpekontakt	Contactora J7KN-32 24VAC without auxiliary contact	Schütz J7KN-32 24VAC ohne Hilfsschütz



	DK	GB	DE
061 742	Hjælpekontakt, NO J73KN-B-10	Auxiliary contact, NO J73KN-B-10	Hilfsschütz, NO J73KN-B-10
061 743	Hjælpekontakt, NC J73KN-B-01	Auxiliary contact, NC J73KN-B-01	Hilfsschütz, NC J73KN-B-01

FR	KR	R	FB	K	DC	DO	ML	SF
X	X	X	X	X	X	X	X	X

EL / POWER / STROM

Relæer / Relays / Relais

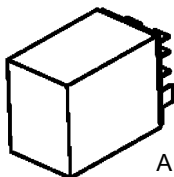

		DK	GB	DE
A	061 525	Relæ LY2 24VAC	Relay LY2 24VAC	Relais LY2 24VAC
A	061 527	Relæ LY2 240VAC	Relay LY2 240VAC	Relais LY2 240VAC
B	061 634	Sokkel LY PTF08AE	Socket LY PTF08AE	Socket LY PTF08AE

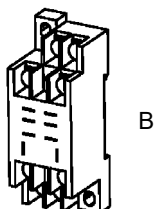

FR	KR	R	FB	K	DC	DO	ML	SF
X	X	X	X	X	X	X	X	X

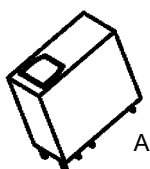

		DK	GB	DE
A	061 550	Relæ, 2-polet 24VAC Schrack	Relay, 2 pole 24VAC Schrack	Relais, 2 Pol 24VAC Schrack
B	061 551	Sokkel, 2 polet 24VAC Schrack	Socket, 2 pole 24VAC Schrack	Socket, 2 Pol 24VAC Schrack

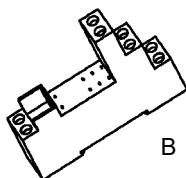

FR	KR	R	FB	K	DC	DO	ML	SF
X	X	X	X	X	X	X	X	X

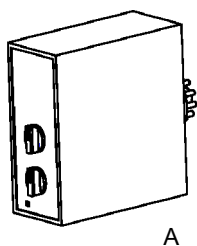

		DK	GB	DE
A	061 311	Relæ spec. 959	Relay spec. 959	Relais spec. 959
B	061 317	Relæ 966 24VAC	Relay 966 24VAC	Relais 966 24VAC

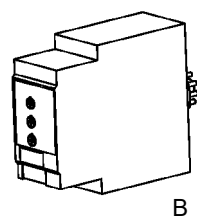

FR	KR	R	FB	K	DC	DO	ML	SF
X	X	X	X			X		

EL / POWER / STROM

Relæer / Relays / Relais

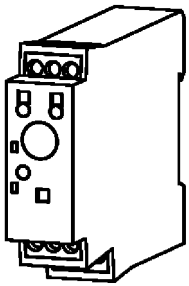

	DK	GB	DE
061 708	Elektronisk tidsrelæ H3DE-S1 24-230	Electronic time relay H3DE-S1 24-230	Elektronisches Zeitrelais H3DE-S1 24-230
061 709	Elektronisk tidsrelæ H3DE-M1 24-230	Electronic time relay H3DE-M1 24-230	Elektronisches Zeitrelais H3DE-M1 24-230

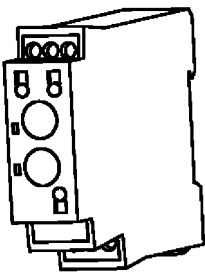

	DK	GB	DE
061 707	Elektronisk tidsrelæ	Electronic time relay	Elektronisches Zeitrelais

FR	KR	R	FB	K	DC	DO	ML	SF
X	X	X	X	X	X	X		X

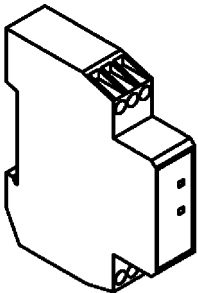

	DK	GB	DE
061 332	Fasebrudsrelæ 3x220V-480V	Fase control relay 3x220V-480V	Relais Phasenkontrolle 3x220V-480V

FR	KR	R	FB	K	DC	DO	ML	SF
X	X	X	X	X	X	X		X

EL / POWER / STROM

Relæer / Relays / Relais

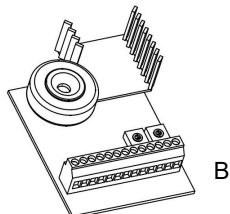
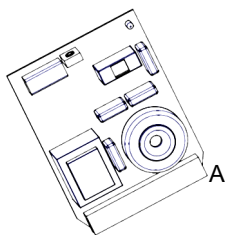

		DK	GB	DE
A	061 573	Relæ f/hastighedsregulator	Relay f/fan speed control	Relais f/Geschwindigkeits-
B	061 578	Relæ til hastighedsregulator til lufttæppe ES-37 8A	Relay for fan speed control for air curtain ES-37 8A	Relais für Geschwindigkeitsregler für Luftteppich ES-37 8A

FR	KR	R	FB	K	DC	DO	ML	SF
X	X	X	X	X	X	X	X	

EL / POWER / STROM

Hovedafbryder / Main switch / Hauptschalter

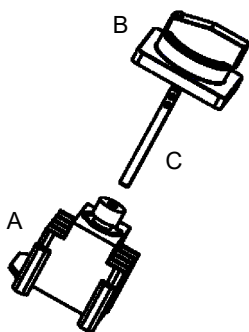

		DK	GB	DE
	Til / For / Für	DIN skinne montage	DIN rail mounting	DIN-Schiene Montage
A	060 971	Lastafbryder 25A 4p	Main switch 25A 4p	Hauptschalter 25A 4p
A	060 982	Lastafbryder 32A 4p	Main switch 32A 4p	Hauptschalter 32A 4p
A	060 984	Lastafbryder 40A 3p UL	Main switch 40A 3p UL	Hauptschalter 40A 3p UL
A	060 985	Lastafbryder 40A 4p	Main switch 40A 4p	Hauptschalter 40A 4p
A	060 986	Lastafbryder 63A 4p	Main switch 63A 4p	Hauptschalter 63A 4p
A	060 987	Lastafbryder 63A 3p	Main switch 63A 3p	Hauptschalter 63A 3p
A	060 977	Lastafbryder 125A 3p	Main switch 125A 3p	Hauptschalter 125A 3p
	060 949	Kontakt f/lastafbryder	Switch f/main switch	Kontakt f/Hauptschalter
B	060 988	Håndtag 1-0 rød/gul	Handle 1-0 red/yellow	Griff 1-0 rot/gelb
C	060 990	Aksel til håndtag 105mm	Shaft for handle 105mm	Achse für Griff 105mm
C	060 993	Aksel til håndtag 180mm	Shaft for handle 180mm	Achse für Griff 180mm
C	060 991	Aksel til håndtag 210mm	Shaft for handle 210mm	Achse für Grill 210mm

	Til / For / Für	Front montage	Front mounting	Front Montage
A	060 994	Lastafbryder 25A 4p	Main switch 25A 4p	Hauptschalter 25A 4p
A	060 995	Lastafbryder 125A 3p	Main switch 125A 3p	Hauptschalter 125A 3p
A	060 996	Lastafbryder 80A 3p	Main switch 80A 3p	Hauptschalter 80 A 3p
A	060 998	Lastafbryder 40A 4p	Main switch 40A 4p	Hauptschalter 40A 4p
A	060 999	Lastafbryder 63A 4p	Main switch 63A 4p	Hauptschalter 63A 4p
B	060 992	Håndtag 1-0 rød/gul	Handle 1-0 red/yellow	Griff 1-0 rot/gelb

FR	KR	R	FB	K	DC	DO	ML	SF
X	X	X	X	X	X	X	X	X

EL / POWER / STROM

Strømforsyning / Power Supply / Stromversorgung

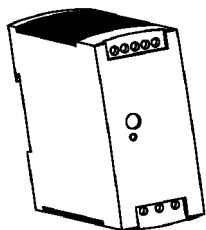

	DK	GB	DE
060 319	Strømforsyning lys/TSC 24VDC 1,25A	Power Supply licht/TSC 24VDC 1,25A	Stromversorgung Licht/TSC 24VDC 1,25A

FR	KR	R	FB	K	DC	DO	ML	SF
X	X	X	X	X	X	X		X

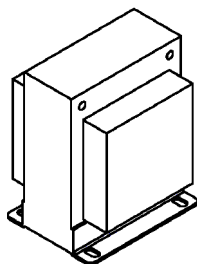

	DK	GB	DE
061 826	Trafo 240-220-200V 24VAC 50VA	Trafo 240-220-200V 24VAC 50VA	Trafo 240-220-200V 24VAC 50VA
061 840	Trafo 230/24V 120VA	Trafo 230/24V 120VA	Trafo 230/24V 120VA
061 842	Trafo 230/24V 50VA	Trafo 230/24V 50VA	Trafo 230/24V 50VA

FR	KR	R	FB	K	DC	DO	ML	SF
X	X	X	X	X	X	X	X	X

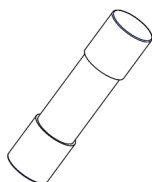

	DK	GB	DE
062 037	Sikring 3,15 A	Fuse 3,15 A	Sicherung 3,15 A
062 038	Sikring 6,3 A	Fuse 6,3 A	Sicherung 6,3 A

FR	KR	R	FB	K	DC	DO	ML	SF
X	X	X	X	X	X	X	X	X

EL / POWER / STROM

Spjældmotor / Flap motor / Klappenmotor

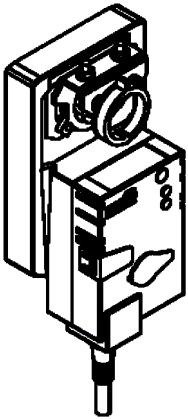

	DK	GB	DE
015 232	Spjældmotor til SL SM24A	Flap motor for ML AM24	Klappenmotor für ML AM24

FR	KR	R	FB	K	DC	DO	ML	SF
							X	

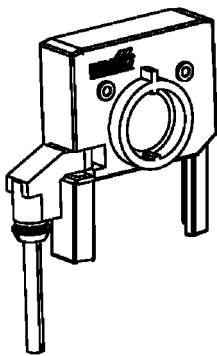

	DK	GB	DE
015 233	Potentiometer til SM24A	Potentiometer for SM24A	Potentiometer für SM24A

FR	KR	R	FB	K	DC	DO	ML	SF
							X	

KØL / COOLING / KÜHLUNG

Fordamper / Evaporator / Verdampfer

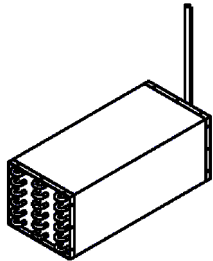

DK

GB

DE

2006 1430	Fordamper 3 kW, R404	Evaporator 3 kW, R404	Verdampfer 3 kW, R404
2006 1432	Fordamper 2,25 kW, R404	Evaporator 2,25 kW, R404	Verdampfer 2,25 kW, R404
2006 1434	Fordamper 1,5 kW, R404	Evaporator 1,5 kW, R404	Verdampfer 1,5 kW, R404
2006 1436	Fordamper 0,6 kW, R404	Evaporator 0,6 kW, R404	Verdampfer 0,6 kW, R404

FR	KR	R	FB	K	DC	DO	ML	SF
X	X		X	X				

DK

GB

DE

2006 1437	Fordamper 3 kW, R134A	Evaporator 3 kW, R134A	Verdampfer 3 kW, R134A
2006 1438	Fordamper 2,25 kW, R134A	Evaporator 2,25 kW, R134A	Verdampfer 2,25 kW, R134A
2006 1439	Fordamper 1,5 kW, R134A	Evaporator 1,5 kW, R134A	Verdampfer 1,5 kW, R134A

FR	KR	R	FB	K	DC	DO	ML	SF
			X	X				

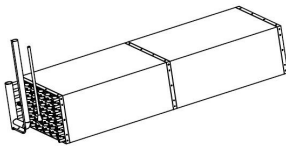

DK

GB

DE

2006 1970	Fordamper 4 kW, R449A	Evaporator 4 kW, R449A	Verdampfer 4 kW, R449A
2006 1982	Fordamper 6 kW, R449A	Evaporator 6 kW, R449A	Verdampfer 6 kW, R449A

FR	KR	R	FB	K	DC	DO	ML	SF
					X	X		

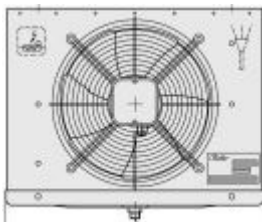

DK

GB

DE

013 745	Fordamper Roller HVST-706-EP	Evaporator Roller HVST-706-EP	Verdampfer Roller HVST-706-EP
---------	------------------------------	-------------------------------	-------------------------------

FR	KR	R	FB	K	DC	DO	ML	SF
							X	

KØL / COOLING / KÜHLUNG

SupraCooler / SupraCooler / SupraCooler

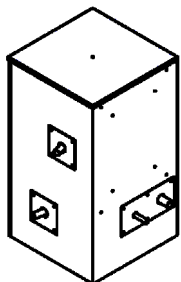

DK

GB

DE

1302 0040	SupraCooler 8 kW	SupraCooler 8 kW	SupraCooler 8 kW
1302 0042	SupraCooler 16 kW	SupraCooler 16 kW	SupraCooler 16 kW

FR	KR	R	FB	K	DC	DO	ML	SF
					X		X	

TILBEHØR / ACCESSORIES / ZUBEHÖR

Fugemasse / Sealant / Dichtungsmittel

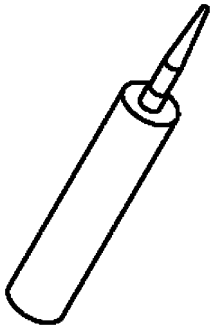

	DK	GB	DE
012 777	Sikaflex 221, grå <i>Montage af stål gulve.</i>	Sikaflex 221, gray <i>Installation of stainless steel floors.</i>	Sikaflex 221, grau <i>Montage von Edelstahlböden.</i>
012 778	Sikaflex 11FC, brun <i>Fugning af Hexafloor gulve.</i>	Sikaflex 11FC, brown <i>Jointing of Hexafloor flooring</i>	Sikaflex 11FC, braun <i>Abdichtung von Hexafloor-Böden.</i>
012 779	Sikaflex 221, sort <i>Fugning af vinduer.</i>	Sikaflex 221, black <i>Jointing of windows.</i>	Sikaflex 221, schwarz <i>Abdichtung von Fenstern.</i>
012 781	Silicone, transparent <i>Fugning af paneler med rustfri plader.</i>	Silicone, transparent <i>Jointing of stainless steel panels.</i>	Silicone, transparent <i>Abdichtung von Edelstahl-paneelen.</i>
012 782	Silicone, hvid <i>Fugning af paneler med hvid overflade.</i>	Silicone, white <i>Jointing of white-coated panels.</i>	Silicone, weiß <i>Abdichtung von weiß lackierten Paneelen.</i>

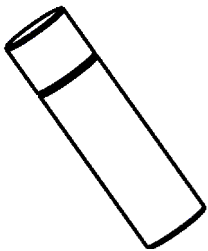

	DK	GB	DE
012 786	Sika isoleringsskum, 700 ml <i>Opskumning af rør- og kabelgennemføringer.</i>	Sika insulation foam, 700 ml <i>Foaming of lead-in piping and cables.</i>	Sika Isolierschaum, 700 ml <i>Schäumen von Rohr- und Kabeldurchführungen.</i>
012 787	Sika isoleringsskum, 250 ml <i>Opskumning af rør- og kabelgennemføringer.</i>	Sika insulation foam, 250 ml <i>Foaming of lead-in piping and cables.</i>	Sika Isolierschaum, 250 ml <i>Schäumen von Rohr- und Kabeldurchführungen.</i>

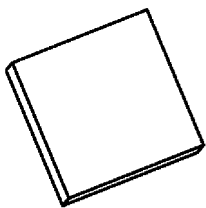

	DK	GB	DE
010 454	Premium tætningsgummi, 7,5 m rulle <i>Forsegling af rør- og</i>	Premium sealing gum, 7,5 m roll <i>Sealing of lead-in piping</i>	Premium Versiegelung Gummi, 7,5 m Rollen <i>Abdichtung von Rohr- und</i>

Lillnord A/S
Knudsminde 2
DK-8300 Odder

Phone: +45 8780 3130
Fax: +45 8780 3131
E-mail: mail@lillnord.dk